

Motor Programming for Roller & Montage™ Shades

1: SETTING UP THE MOTOR: During the settings, the interval between two operations must be less than 6 seconds to keep the motor in the programming mode.

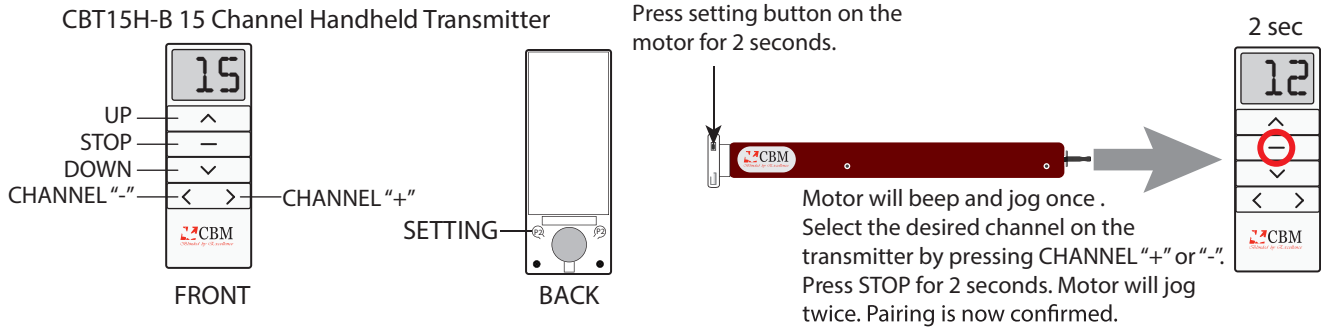

2. MOTOR ROTATION:

Press UP or DOWN .

When pressing UP or DOWN shade should travel in the correct direction. If it travels in the opposite direction, press UP + DOWN key together for 2 seconds, shade will jog once and reverse direction.

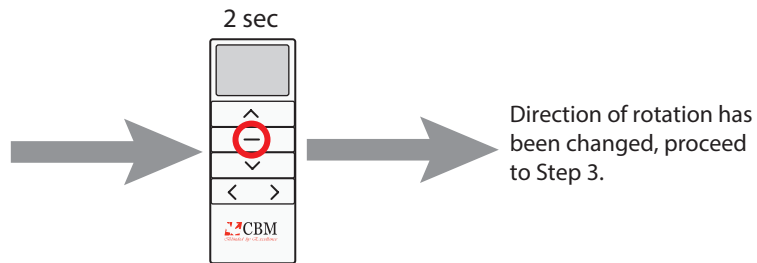

3. SET UP/DOWN LIMITS:

During the limit setting mode, pressing UP or DOWN will make the motor jog in that direction. Long pressing the keys for 2 seconds will move the motor continuously.

Press UP for 2 seconds. Bottom rail will travel upwards. Press STOP to stop the shade at desired UPPER limit. You can adjust the position by short pressing the UP and DOWN keys.
Press UP and STOP for 2 seconds.
Motor will jog twice and record the UPPER limit.

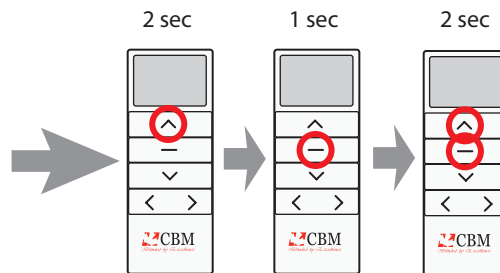

Press DOWN for 2 seconds. Bottom rail will travel downwards. Press STOP to stop the shade at desired LOWER limit. You can adjust the position by short pressing the UP and DOWN keys.
Press DOWN and STOP for 2 seconds.
Motor will jog twice and record the LOWER limit.

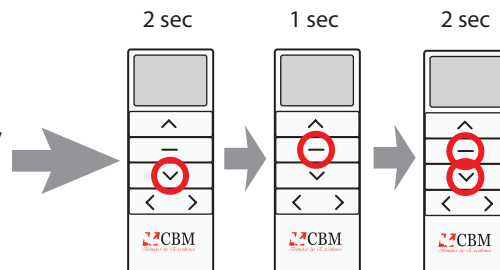

Motor Programming for Roller & Montage™ Shades

4: SETTING FAVOURITE POSITION (OPTIONAL):

After setting UPPER and LOWER limits (stop 3), you can proceed to setup FAVOURITE position.

Bring the shade to its desired position by using UP/DOWN keys and then stopping it where you wish to setup new FAVOURITE position.

Remove the battery cover to in the back to reveal the SETTING button.

Press SETTING button for 1 second. Flip the remote press the the STOP key for 1 second. Motor will jog once. Press STOP again, motor will jog twice. FAVOURITE position is now confirmed.

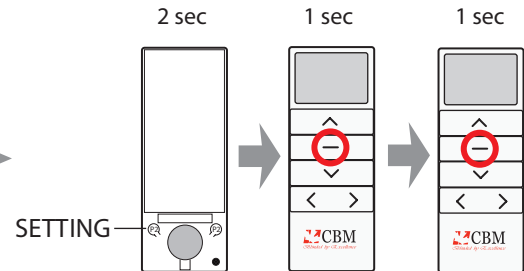

5: ADDING/DELETING A CHANNEL/TRANSMITTER:

Switch to the channel that is pre-programmed to control the desired shade.

Remove the battery cover and press the SETTING button for 1 second. The shade will jog once. Press SETTING again, and the shade will jog once more.

Press CHANNEL "+" or "-" button in the front to switch to the NEW desired channel. Flip the Transmitter and press SETTING once more to record the new channel. The shade will jog twice to confirm the new setting.

You can repeat above steps to delete a channel as well.

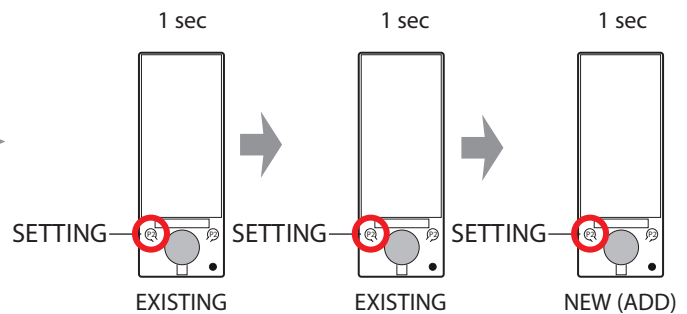

6. FINE TUNING UPPER/LOWER LIMIT (IF NEEDED):

Press UP and STOP for 5 seconds to enter UPPER limit adjustment mode. The shade will jog once.

Press UP or DOWN keys to adjust the shade to its new UPPER limit. Please note that shade remains in jog mode during limit adjustment mode.

Press UP and STOP for 2 seconds to record the new UPPER limit. Shade will jog twice to confirm.

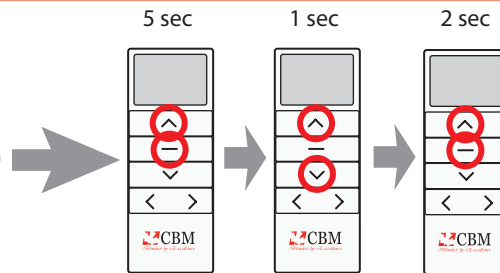

Press DOWN and STOP for 5 seconds to enter LOWER limit adjustment mode. The shade will jog once.

Press UP or DOWN keys to adjust the shade to its new LOWER limit. Please note that shade remains in jog mode during limit adjustment mode.

Press DOWN and STOP for 2 seconds to record the new LOWER limit. Shade will jog twice to confirm.

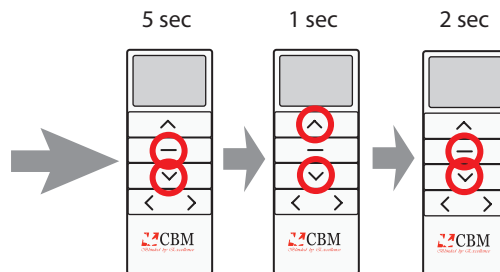

7: RESETTING THE MOTOR:

Press the setting button on the motor until the motor jogs 4 times.