

Motor Programming for Cellaris™ Standard Shades

1: SETTING UP THE MOTOR: During the settings, the interval between two operations must be less than 6 seconds to keep the motor in the programming mode.

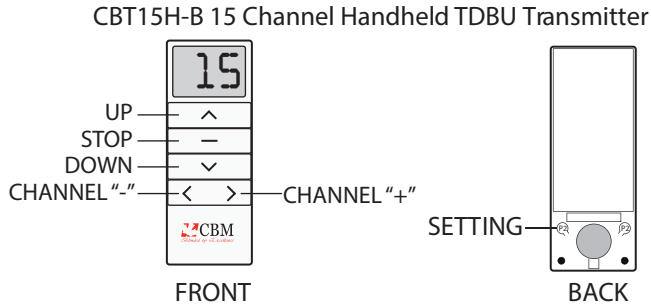

Press setting button on the motor for 2 seconds.



Motor will beep and jog once. Select the desired channel on the transmitter by pressing CHANNEL "+" or "-". Press STOP for 2 seconds. Motor will jog twice. Pairing is now confirmed.

2 sec

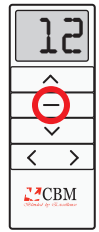

2. MOTOR ROTATION:

Press UP or DOWN.

When pressing UP or DOWN shade should travel in the correct direction. If it travels in the opposite direction, press UP + DOWN key together for 2 seconds, shade will jog once and reverse direction.

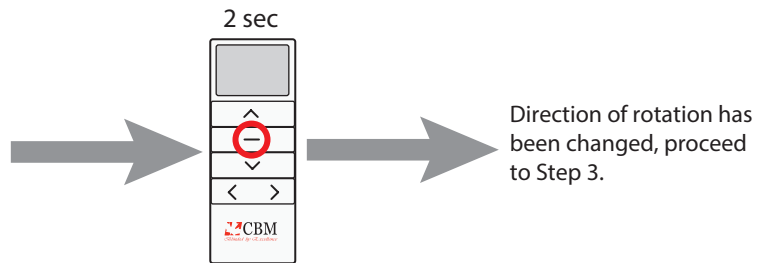

3. SET UP/DOWN LIMITS:

During the limit setting mode, pressing UP or DOWN will make the motor jog in that direction. Long pressing the keys for 2 seconds will move the motor continuously.

Press UP for 2 seconds. Bottom rail will travel upwards. Press STOP to stop the shade at desired UPPER limit. You can adjust the position by short pressing the UP and DOWN keys. Press UP and STOP for 2 seconds. Motor will jog twice and record the UPPER limit.

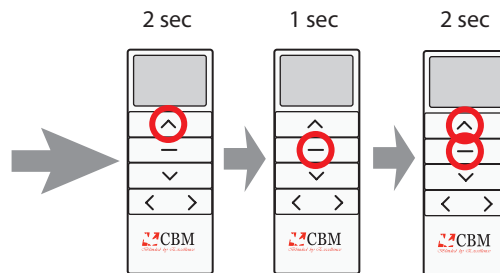

Press DOWN for 2 seconds. Bottom rail will travel downwards. Press STOP to stop the shade at desired LOWER limit. You can adjust the position by short pressing the UP and DOWN keys. Press DOWN and STOP for 2 seconds. Motor will jog twice and record the LOWER limit.

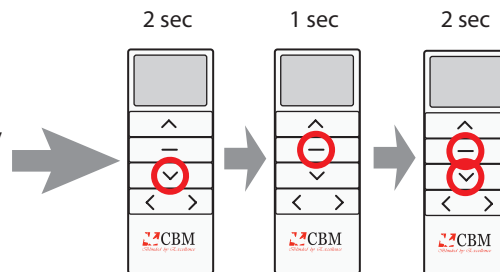

Motor Programming for Cellaris™ Standard Shades

4: SETTING FAVOURITE POSITION (OPTIONAL):

After setting UPPER and LOWER limits (stop 3), you can proceed to setup FAVOURITE position.

Bring the shade to its desired position by using UP/DOWN keys and then stopping it where you wish to setup new FAVOURITE position.

Remove the battery cover to in the back to reveal the SETTING button.

Press SETTING button for 1 second. Flip the remote press the the STOP key for 1 second. Motor will jog once. Press STOP again, motor will jog twice. FAVOURITE position is now confirmed.

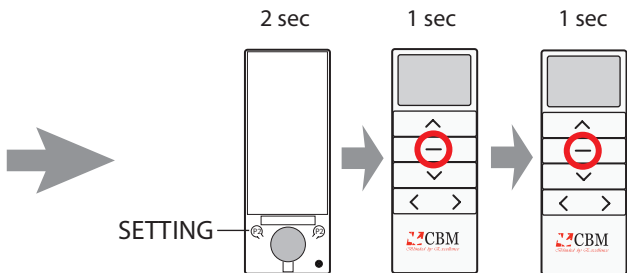

5: ADDING/DELETING A CHANNEL/TRANSMITTER:

Switch to the channel that is pre-programmed to control the desired shade.

Remove the battery cover and press the SETTING button for 1 second. The shade will jog once. Press SETTING again, and the shade will jog once more.

Press CHANNEL "+" or "-" button in the front to switch to the NEW desired channel. Flip the Transmitter and press SETTING once more to record the new channel. The shade will jog twice to confirm the new setting.

You can repeat above steps to delete a channel as well.

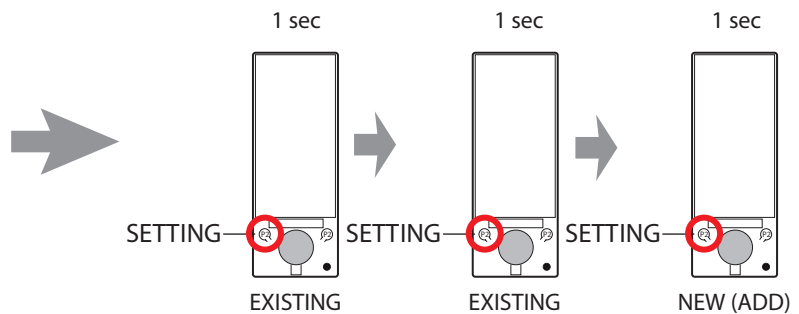

6. FINE TUNING UPPER/LOWER LIMIT (IF NEEDED):

Press UP and STOP for 5 seconds to enter UPPER limit adjustment mode. The shade will jog once.

Press UP or DOWN keys to adjust the shade to its new UPPER limit. Please note that shade remains in jog mode during limit adjustment mode.

Press UP and STOP for 2 seconds to record the new UPPER limit. Shade will jog twice to confirm.

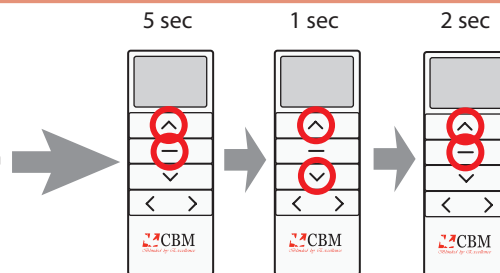

Press DOWN and STOP for 5 seconds to enter LOWER limit adjustment mode. The shade will jog once.

Press UP or DOWN keys to adjust the shade to its new LOWER limit. Please note that shade remains in jog mode during limit adjustment mode.

Press DOWN and STOP for 2 seconds to record the new LOWER limit. Shade will jog twice to confirm.

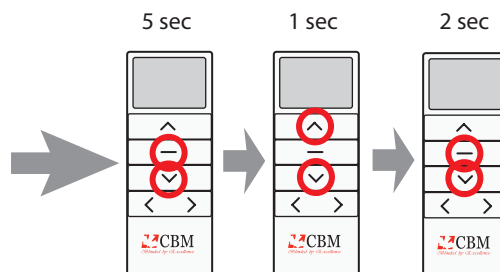

7: RESETTING THE MOTOR:

Press the setting button on the motor until the motor jogs 4 times.

Motor Programming for Cellaris™ TDBU Shades

1: SETTING UP THE MOTOR: During the settings, the interval between two operations must be less than 6 seconds to keep the motor in the programming mode.

CBT15H-TD 15 Channel Handheld TDBU Transmitter

Press setting button on the motor for 2 seconds.

Motor will beep and jog once. Select the desired channel on the transmitter by pressing CHANNEL "+" or "-". Press STOP (A) for 2 seconds. Motor will jog twice. Pairing is now confirmed.

2. MOTOR ROTATION:

Press UP (A) or DOWN (A). When pressing UP (A) or DOWN (A) shade should travel in the correct direction. If it travels in the opposite direction, press UP (A) + DOWN (A) key together for 2 seconds, shade will jog once and reverse direction.

Direction of rotation has been changed, proceed to Step 3.

3. SET UP/DOWN LIMITS:

During the limit setting mode, pressing UP (A) or (B) and DOWN (A) or (B) will make the motor jog in that direction. Long pressing the keys for 2 seconds will move the motor continuously.

Press UP (B) for 2 seconds. Middle rail will travel upwards. Press STOP (B) to stop the shade at desired UPPER limit for the middle rail. Press UP (A) for 2 seconds. Bottom rail will travel upwards. Press STOP (A) to stop the shade at its UPPER limit. Press UP (A) and STOP (A) for 2 seconds. Motor will jog twice and record the UPPER limit.

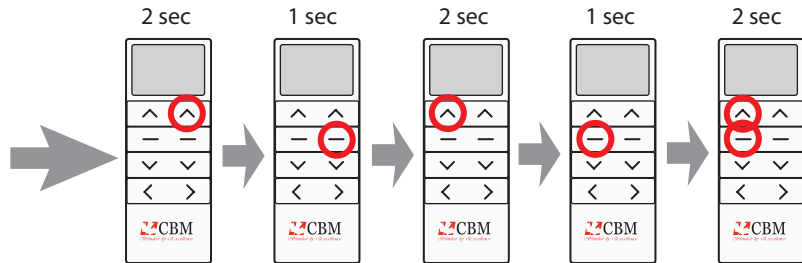

Press DOWN (A) for 2 seconds. Bottom rail will travel downwards. Press STOP (A) to stop the shade at desired LOWER limit for the bottom rail. Press DOWN (B) for 2 seconds. Middle rail will travel downwards. Press STOP (B) to stop the rail at its LOWER limit. Press DOWN (A) and STOP (A) for 2 seconds. Motor will jog twice and record the LOWER limit.

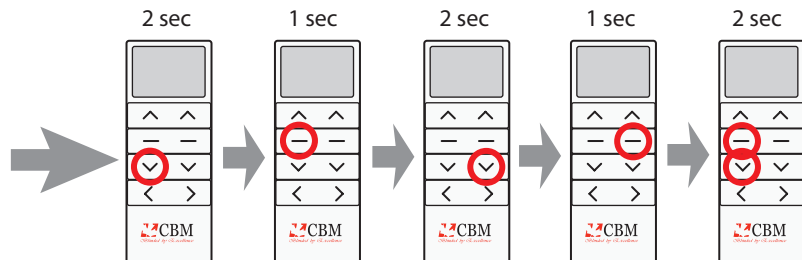

Motor Programming for Cellaris™ TDBU Shades

4: SETTING FAVOURITE POSITION (OPTIONAL):

After setting UPPER and LOWER limits (step 3), you can proceed to setup FAVOURITE (A) Position.

Bring the shade to its desired position by using UP/DOWN keys and then stopping it where you wish to setup new FAVOURITE position.

Remove the battery cover in the back to reveal SETTING (A) & SETTING (B) buttons. Press SETTING (A) for 1 second. Motor will jog once. Flip the remote and press the STOP (A) for 1 second. Motor will jog once. Press STOP (A) again, motor will jog twice. Favourite (A) is now confirmed.

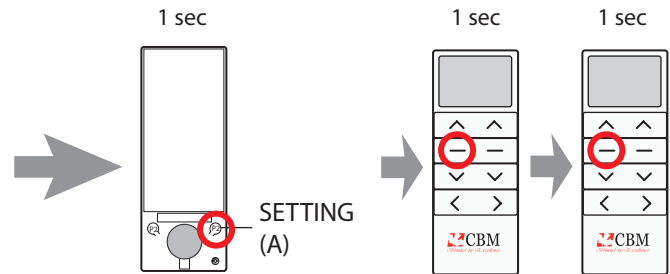

5: ADDING/DELETING A CHANNEL/TRANSMITTER:

Switch to the channel that is pre-programmed to control the desired shade.

Remove the battery cover and press the SETTING (A) button for 1 second. The shade will jog once. Press SETTING (A) again, and the shade will jog once more.

Press CHANNEL "+" or "-" button in the front to switch to the NEW desired channel. Flip the Transmitter and press SETTING (A) once more to record the new channel.

You can repeat above steps to delete a channel as well.

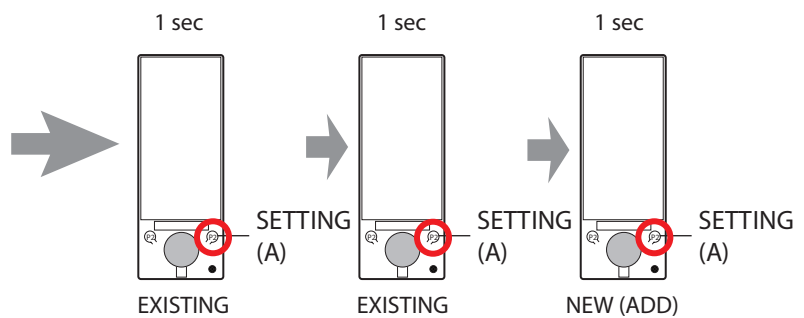

6. FINE TUNING UPPER/LOWER LIMIT (IF NEEDED):

Press UP (A) and STOP (A) for 5 seconds to enter UPPER limit adjustment mode. The shade will jog once.

Press UP (B) or DOWN (B) to bring the middle rail to desired position. Press UP (A) or DOWN (A) to bring the bottom rail to desired position; new UPPER limit. Press UP (A) and STOP (A) for 2 seconds to record the new UPPER limit. Shade will jog twice to confirm.

Press DOWN (A) and STOP (A) for 5 seconds to enter LOWER limit adjustment mode. The shade will jog once.

Press UP (A) or DOWN (A) to bring the bottom rail to desired position. Press UP (B) or DOWN (B) to bring the middle rail to desired position; new LOWER limit. Press DOWN (A) and STOP (A) for 2 seconds to record the new LOWER limit. Shade will jog twice to confirm.

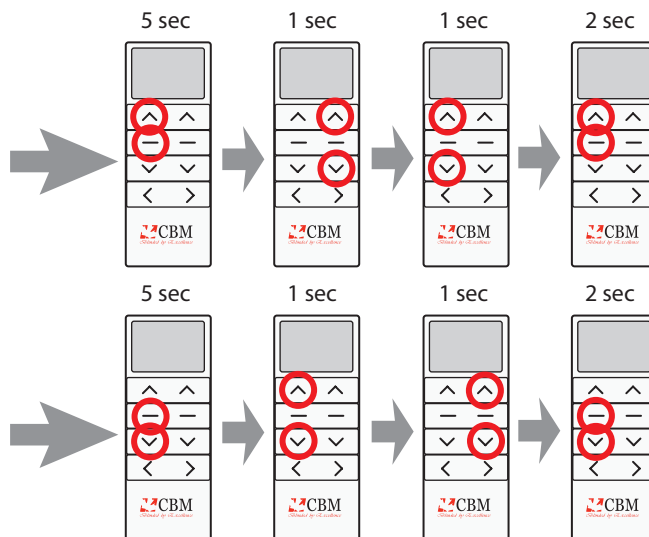

7: RESETTING THE MOTOR:

Press the setting button on the motor until the motor jogs 4 times.

Network Bridge

Technical:

Voltage	5V DC	Device Limit	30
Control	Bi-directional	Room Limit	20
Wi-Fi Connection Type	2.4GHz 802.11b/g/n	Scene Limit	20
Additional Interface	RS485	Supported OS	iOS & Android
Working Temperature	-10°C ~ 50°C	Firmware Update	Yes

Dimensions:

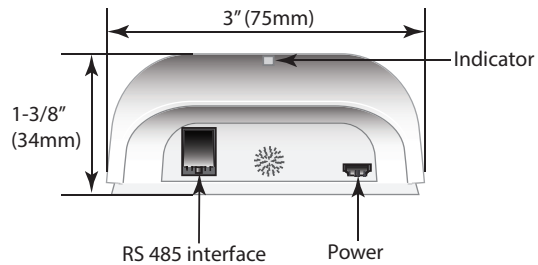
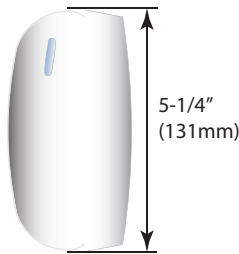

Features:



Precise Control



USB Powered



RS485 Interface



Scene Control



Limit Adjustment



Smartphone & Tablet
Control (iOS & Android)



Timer Control



Status Feedback



Voice control with Google
Home & Amazon Alexa

Setup requires Wi-Fi router, not included in the package. Voice control features requires additional smart home devices. Please contact customer service for more details.

Typical Layout:

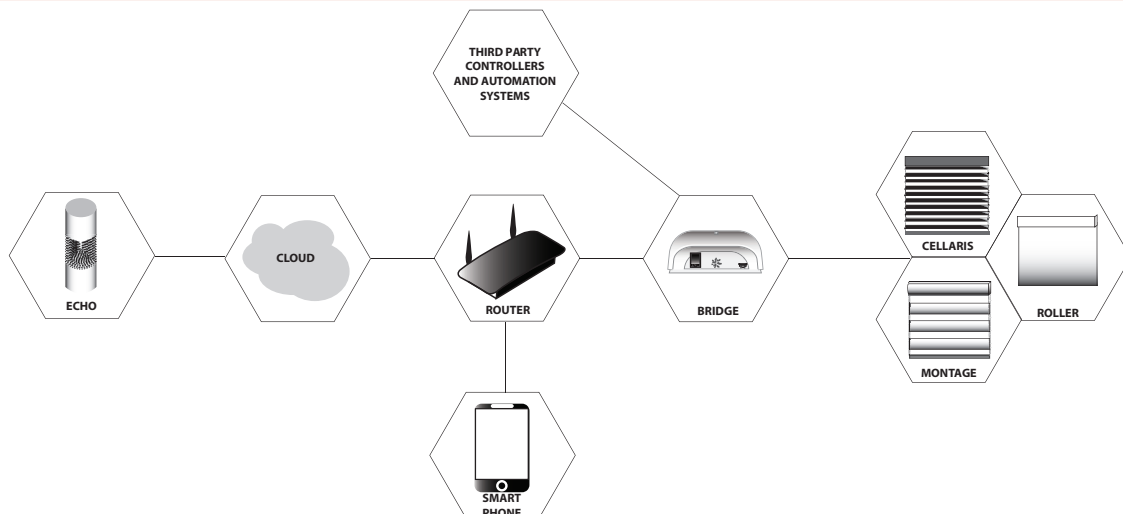

Network Bridge

Step 1:



Download and install Shade Connector. Available on iOS and Android.

Step 2:

Open the downloaded app and sign up for a new account. Once signed in, click on "Add New Bridge" and choose your wireless connection. Enter username and password for your wireless connection.

Step 3:

Plug Network Bridge into USB power source (USB cable is included). The indicator light will start to flash purple after a few seconds indicating pairing mode. If it doesn't enter pairing mode automatically, press the setup button on the back for 2 seconds. The indicator light on the bridge will begin flashing purple.

Step 4:

Go to your device's wireless setting and connect to device labelled as "connector_XXXX". Please ensure that the device is configured to remain connected to this connection.

Step 5:

Return to your previous screen with Connector app. Indicator light on the bridge will cycle through red and green led and then finally turn solid blue. That indicates successful pairing with the wireless router. Network Bridge is now fully setup, follow on screen instructions to setup shades, rooms, scenes & timers.

For detailed instructions, follow us on our YouTube channel at www.youtube.com/empcbm.